

Grease bearings

RPM-MAX-10000

Runout taper 0.002mm

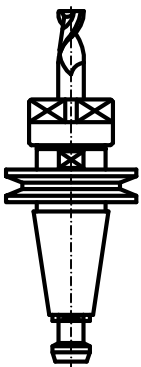

ARBOR ISO40 DIN 69871

- 1-Coolant inlet (G1/2")
- 2-Coolant outlet (G1/2")
- 3-Hydraulic pressure unclamping tool (50bar max) (G1/4")
- 4-Hydraulic pressure clamping tool (50bar max) (G1/4")
- 6-Outlet sensor's cables (S1-S2-S4)
S1 = Tool's arbor clamped.
S2 = Piston under pressure ready to receive tools arbor.
The electrosppindle can not turn.
- S4 = Tool's arbor not clamped.
The electrosppindle cannot turn.
- 7-Front-side pressurization (G1/8")
- 16-Rear-side pressurization
- 17-Tool's Lubro refrigerant inlet by rotary joint(G1/4")
+ inlet air arbor's cleaning



SUBJECT: PS M-160-T-SP
CUSTOMER :

Sheet: 1/1 DTS. N°723-00

DATE : 02/05/2008