

1 - Body made in castiron  
2 - Electrospindle

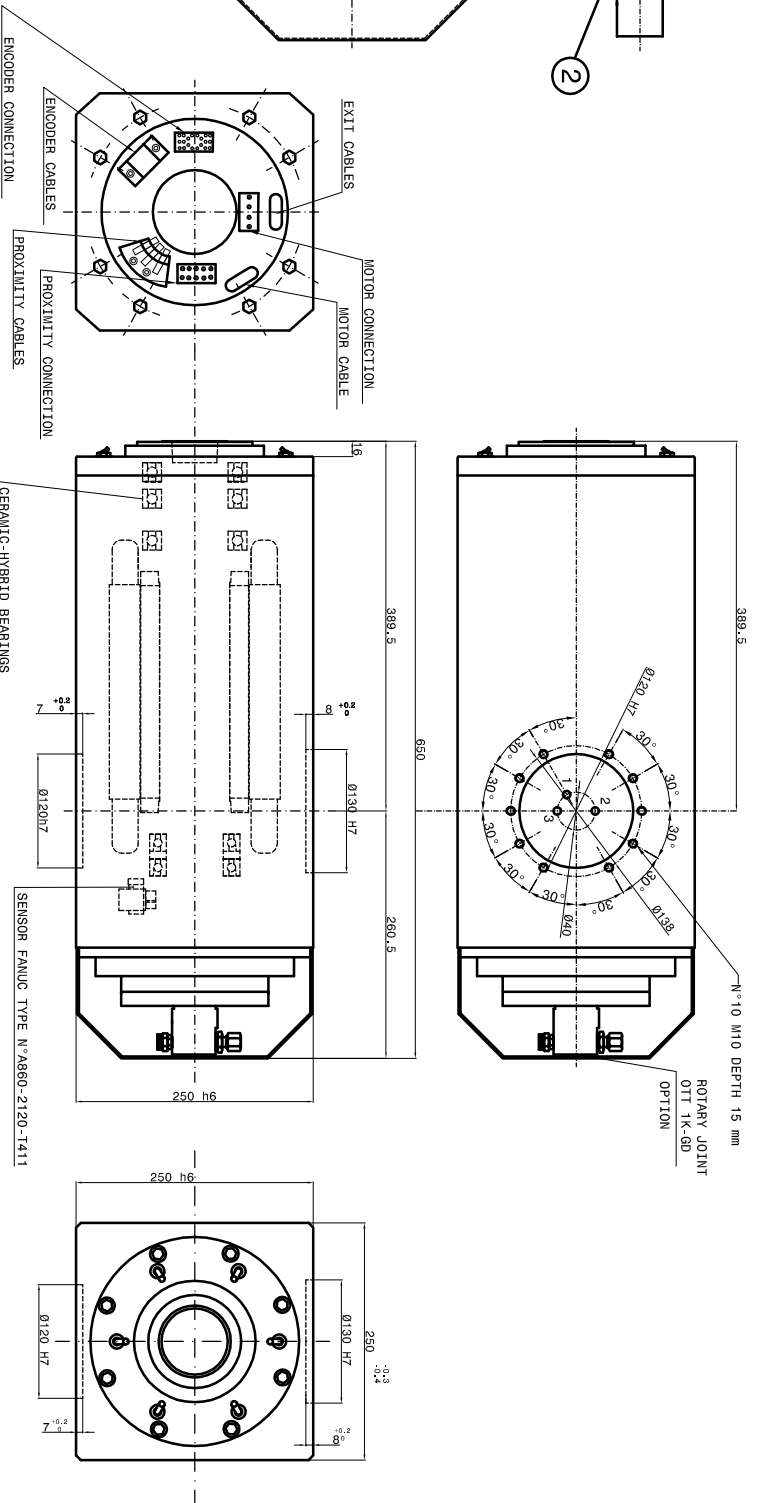

- 1 - Coolant inlet (Ø8)
- 2 - Coolant outlet (Ø8)
- 3 - Hydraulic pressure unclamping tool (50bar max) (Ø8)
- 4 - Hydraulic pressure clamping tool (50bar max) (Ø8)
- 5 - Electric connection  
3phases motor (Ø7) - Earth (Ø7)  
Motor thermich switch (N°2 KTY) - (Ø5)  
Outlet sensor's cables (S1-S2-S4)  
S1 = Tool's arbor clamped. (Ø 5)  
S2 = Piston under pressure ready (Ø5) to receive tools arbor.  
The electrospindle cannot turn.  
S4 = Tool's arbor not clamped (Ø 5)  
The electrospindle cannot turn.  
Outlet encoder's cables  
(Sensor Fanuc type N°A860-2120-1411) (Ø 6)
- 6 - Front-side pressurization (Ø6)
- 7 - Front bearings Lubrication 1 (Ø6)
- 8 - Front bearings Lubrication 2 (Ø6)
- 9 - Front bearings Lubrication 3 (Ø6)
- 10 - Rear bearings Lubrication 1-2 (Ø6)
- 11 - Unloading Lubrication bearings (Ø6)
- 12 - Tool's Lubro refrigerant inlet by rotary joint (Ø6)  
+ inlet air arbor's cleaning
- 13 - Rear-side pressurization
- 14 - Rotary joint leakage outlet
- 15 - Tool cooling (Ø6)

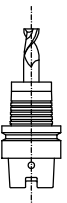
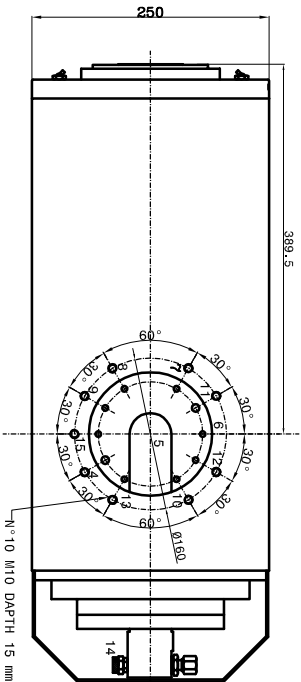
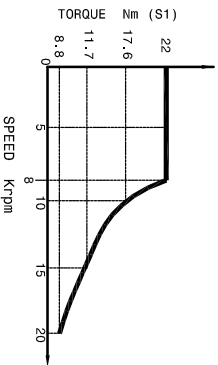
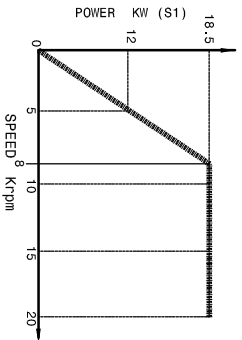

ARBOR HSK-A63 / A80  
DIN 69873

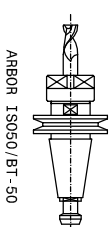

ARBOR IS050/BT-50

Runout taper 0.002mm

Air-Oil bearings Lubrication



SUBJECT : PS ES-5  
CUSTOMER :