

- ① Body made in castiron
- ② Electrospindle
- ③ Piston

- 1 - Coolant inlet (Ø5)(3bar)
- 2 - Coolant outlet (Ø5)
- 3 - Continuous inlet filtered air 0.5 MICRON for pressurization (1-1.5 bar MAX) (Ø5)
- 4 - Inlet oil tool change (50 bar) (to be used only with arrested electrospindle) (Ø5)
- 5 - Inlet air arbor's cleaning (6 bar) (please use only and exclusively with released tool and piston under pressure The electrospindle cannot turn. (Ø5)
- 6 - Electric connection

Phases motor - Earth  
 Motor thermich switch (N°2 KTY)(NC)  
 Outlet sensor's cables (S1-S2-S4)  
 S1 = Tool's arbor clamped.  
 S2 = Piston under pressure ready to receive tools arbor.  
 The electrospindle can not turn.  
 S4 = Tool's arbor not clamped  
 The electrospindle cannot turn.  
 Themich sensor bearings  
 -Outlet encoder's cables (Gel 2442 KN)  
 -Outlet front bearings temperature's sensor cables (PT100)  
 -Outlet rear bearings temperature's sensor cables (PT100)

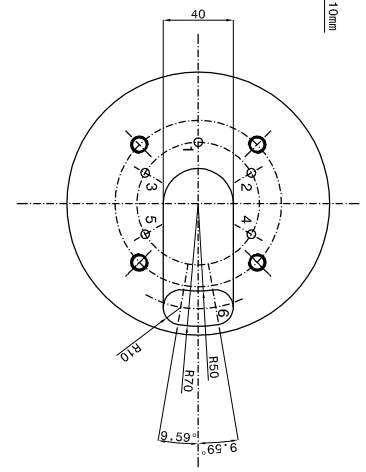
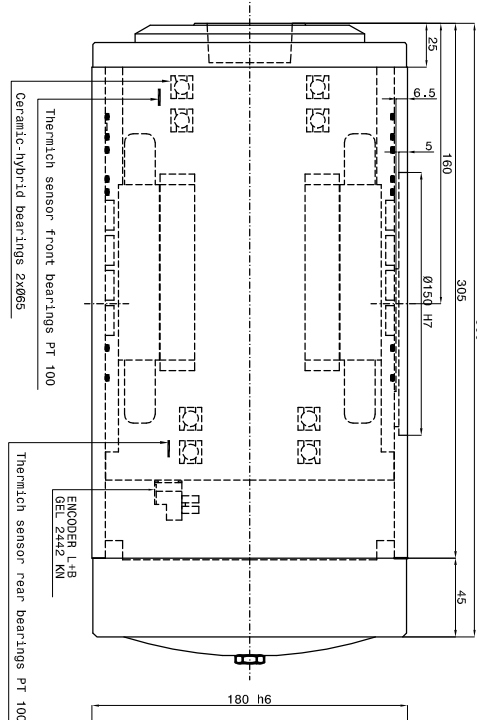
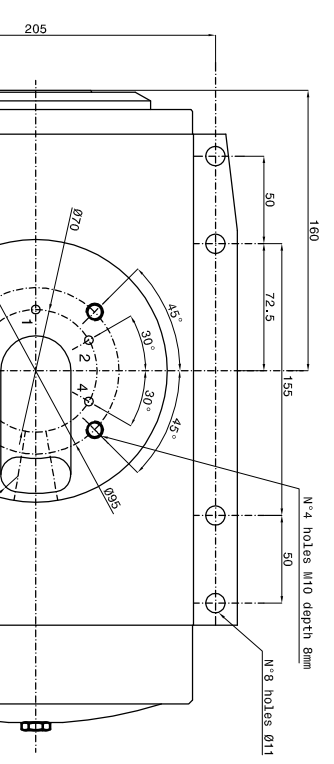
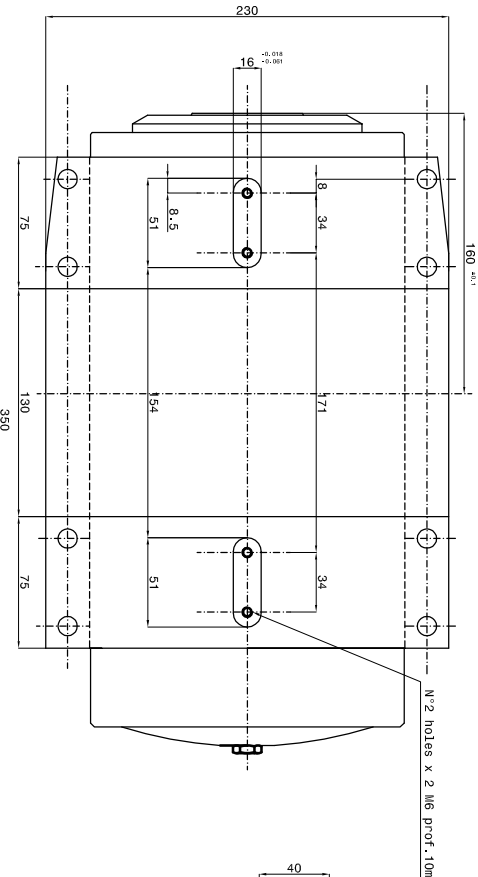
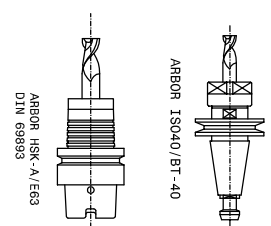
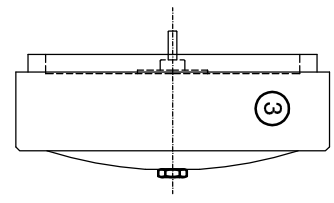

SPEED	3000	10000	20000	22000
FREQUENCY	Hz	100	333	667
POWER (S1)	KW	8	15	15
TORQUE (S1)	Nm	25	14	7
TENSION	V	105	350	350
CURRENT	A	62	38	35
				34

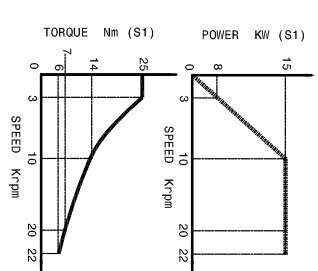

Motor : 4 pole  
 Runout taper 0.002mm

**PERON SPEED**  
 SUBJECT : PS ES-3  
 CUSTOMER:

Sheet: 1/1  
 Dwg n° 537-00  
 DATE :

Grease bearings Lubrication