

ARBOR HSK-E32  
DIN 69893

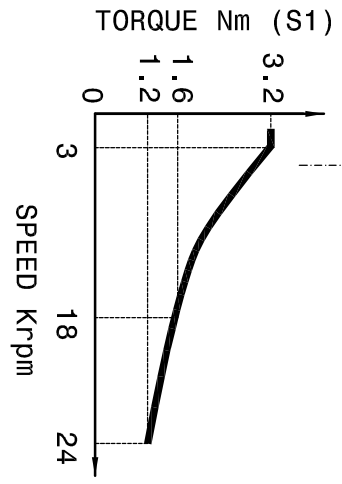

MAX CURRENT 6.4 A - 350 V

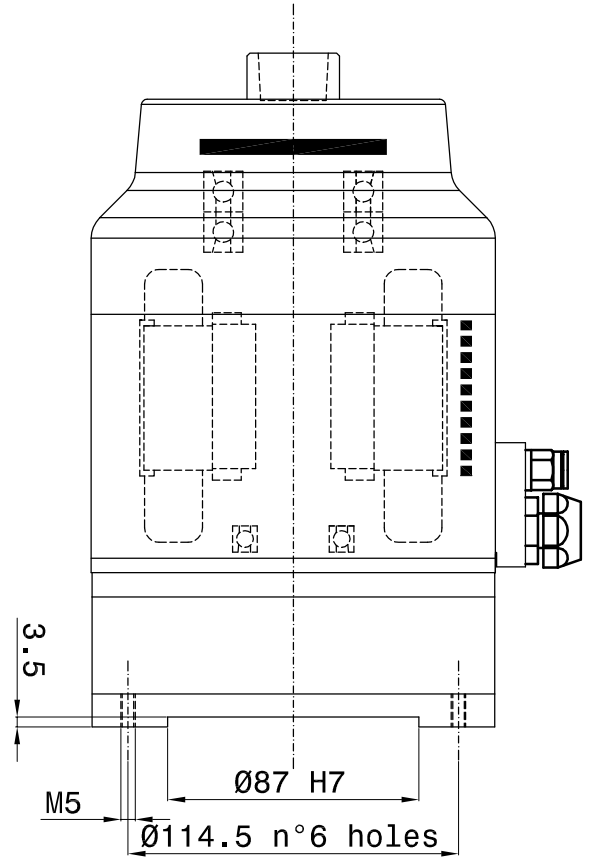
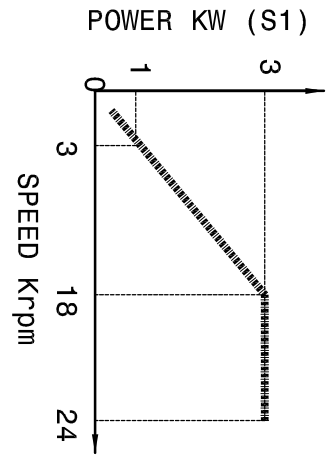

- 1-LIQUID INLET (G 1/8")
- 2-LIQUID OUTLET (G 1/8")
- 3-FRONT PRESSURIZATION (M6)
- 4-ELECTRIC CONNECTION
- 3 MOTOR PHASE + EARTH
- THERMIC SWITCH NC
- S1 = TOOL'S ARBOR CLAMPED.
- 5-TOOL CHANGE AIR INLET (6 bar) (G1/8")

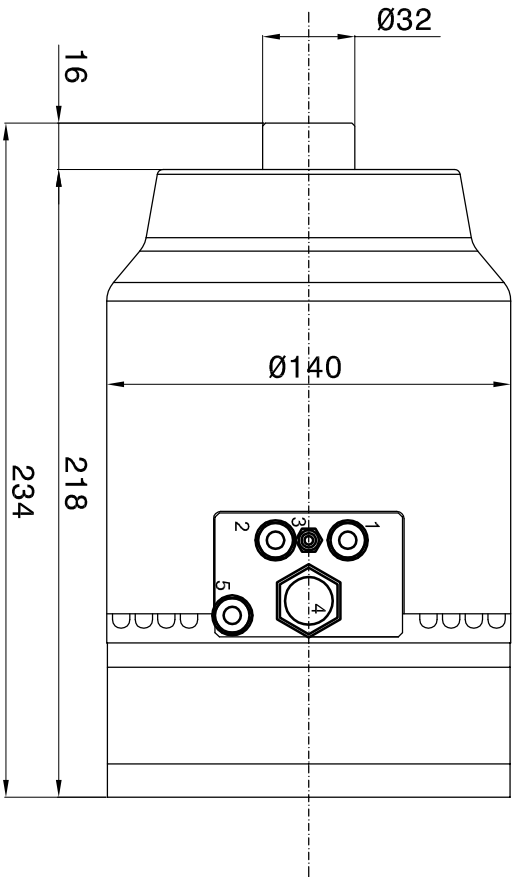

Runout taper 0.002mm

Grease bearings lubrication

Motor : 2 pole

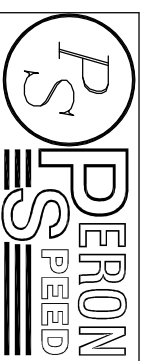

SUBJECT : A-4-TC  
CUSTOMER :