

- 1-Cooling inlet (M6)
 - 2-Cooling outlet (M6)
 - 3-Front pressurisation 1-1.5 Bar (M6)
 - 4-Electric connection
- Motor phases - Earth - Sensor NC

- Asynchronous motor 4 poles
- Max power 4 Kw
- Max torque 4.1 Nm
- Tension 380 V
- Max current 12 A
- Max frequency 1200 Hz
- N°2 Ø 30 front hybrid ceramic bearings
- Bearings's Lubrication by permanent grease
- Manual clamping tools
- Internal cooling by liquid circuit
- Required cooling capacity 1900 Watt
- Weight Kg 14

VERSION PS-A-5P

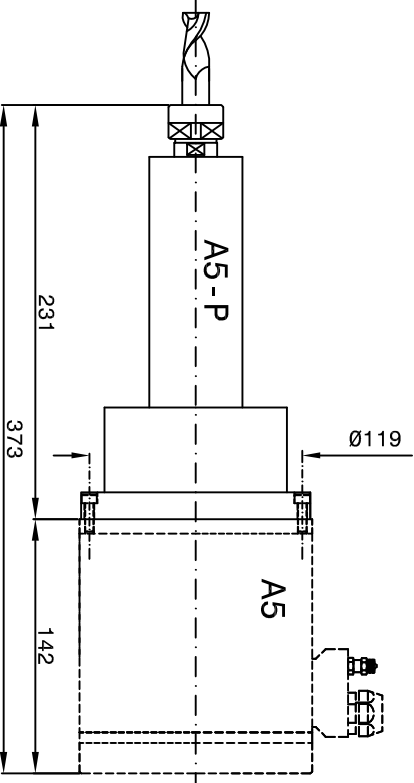
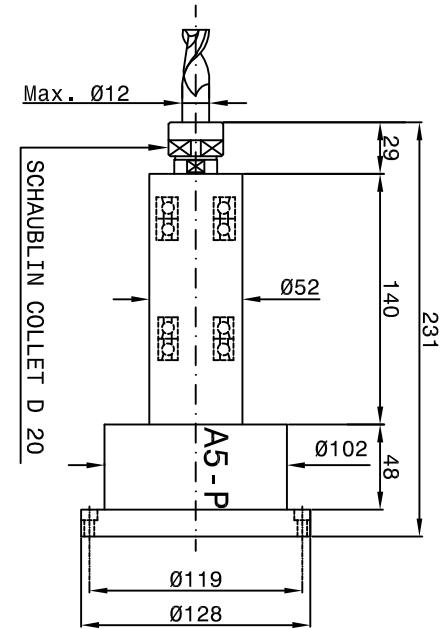

SUBJECT : PS A-5/
PS A-5P
CUSTOMER :

SHEET : 1/1

DATE : 22/12/2008